

**MILLENNIUM MEDICAL
TRI-ATRIA OFFICE BUILDING
32255 NORTHWESTERN HIGHWAY
FARMINGTON HILLS, MI 48334
(North of 13 Mile Rd / West of Middlebelt Rd)**

DIRECTIONS TO MILLENNIUM MEDICAL

From the West: Take 1-96 East to I-696 East. Exit at Orchard Lake Road. Turn Left onto Orchard Lake Road and travel North two miles. Turn Right on 14 Mile Road and make another quick right onto Northwestern Highway. The office is half a mile on the right.

From Detroit: Travel North on the Lodge Freeway (M-10) until it becomes Northwestern Highway. The office is on the left in about three miles.

From the East: Take I-696 West to the Lodge Freeway (M-10) North, then follow the directions above.

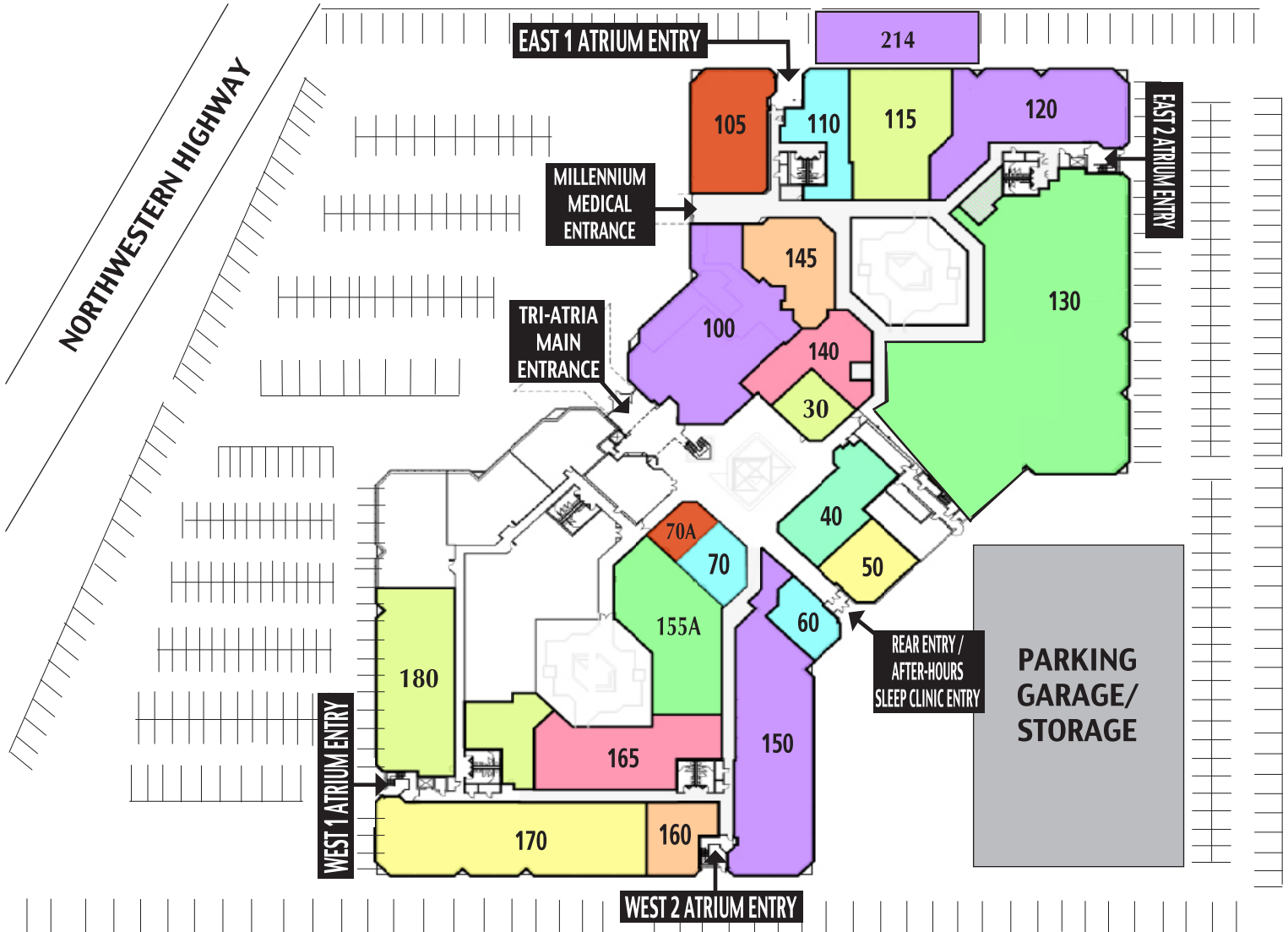

MHP SPECIALTY PHARMACY	30	ASSOCIATED RHEUMATOLOGY CONSULTANTS	120
FRANKLIN NEUROLOGY	40	MILLENNIUM AFFILIATED PHYSICIANS (A-B-C)	130
MILLENNIUM PULMONARY & SLEEP CLINIC	50	BIOTECH CLINICAL LABORATORIES	140
JENNIFER MARGOLIS, M.D., PLLC	60	KESTENBERG BREAST CARE CENTER	145
JEFFREY KERTES, PH.D., PLC	70	OAKLAND MEDICAL GROUP CLINICAL	150
MHP PHARMACY	70	HEMATOLOGY & MEDICAL ONCOLOGY	
BINSON'S HOME HEALTHCARE CENTERS & HOME INFUSION SERVICES	70A	MILLENNIUM REHABILITATION & PHYSICAL THERAPY	155A
MILLENNIUM DIAGNOSTIC CENTER	100	NEWLAND MEDICAL ASSOCIATES	160
MILLENNIUM ORTHOPAEDICS	100	TRI-COUNTY PAIN CONSULTANTS, PC	165
COMPREHENSIVE UROLOGY	105	INTERNAL MEDICINE PHYSICIANS	170
MILLENNIUM FOOT & ANKLE SPECIALISTS	110	PREMIER INTERISTS	180
MILLENNIUM CARDIOLOGY	115	ASSOCIATED ENDOCRINOLOGISTS (2ND FLOOR)	214